

Finger Clamps

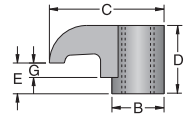

Description	Part No. 733101-	B	C	D	E	G	Thread	Pkg.
CL-5	90680	.280	.52	.350	.102	—	10-32	10
CL-6	90681	.310	.58	.440	.187	.094	10-32	
CL-7	90682	.310	.64	.310	.082	—	10-32	
CL-9	90683	.430	.75	.660	.344	.125	5/16-24	
CL-12	90684	.430	.88	.660	.344	.125	5/16-24	
CL-19	90685	.310	.55	.310	.062	—	10-32	
CL-20	90686	.375	.73	.380	.125	—	1/4-28	
CL-24	90687	.491	1.0	.785	.453	.136	3/8-24	
CL-30	90688	.430	1.0	.660	.344	.125	5/16-24	

Bridge Clamps

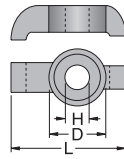

Description	Part No. 733101-	L	D	H	Pkg.
HC-7	90915	.469	.313	.172	10
HC-9	90917	.625	.375	.203	
HC-12	90919	.812	.500	.266	

Negative Lock Pins

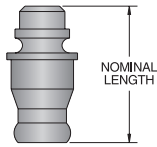

Description	Part No. 733101-	Insert I.C.	Nominal Length	Thread	Hex Wrench Size	Pkg.
NL-23	90472	.250	.328	8-32	1/16	10
NL-33	90473	.375	.344	10-32	5/64	
NL-33L	90474	.375	.406	10-32	5/64	
NL-34	90475	.375	.453	10-32	5/64	
NL-34L	90476	.375	.516	10-32	5/64	
NL-43	90477	.500	.420	10-32	5/64	
NL-44	90478	.500	.516	1/4-28	3/32	
NL-46	90479	.500	.672	1/4-28	3/32	
NL-46L	90480	.500	.730	1/4-28	3/32	
NL-56	90481	.625	.703	5/16-24	1/8	
NL-57	90482	.625	.810	5/16-24	1/8	
NL-58	90483	.625	.859	5/16-24	1/8	
NL-58L	90484	.625	.890	5/16-24	1/8	
NL-66	90485	.750	.703	3/8-24	9/64	
NL-66L	90486	.750	.828	3/8-24	9/64	
NL-68	90487	.750	.859	3/8-24	9/64	
NL-68L	90488	.750	.953	3/8-24	9/64	
NL-808	90489	1.00	.940	7/16-20	5/32	
NL-810	90490	1.00	1.17	7/16-20	5/32	

Bridge Clamp Screws

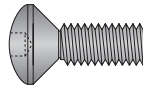

Description	Part No. 733101-	Length	Thread	Hex Wrench Size	Pkg.
SHC-7	90920	.375	8-32	3/32	10
CS-94	90921	.580	10-32	1/8	
CS-96	90923	.840	10-32	1/8	
CS-126	90925	.860	1/4-28	5/32	

Bridge Clamp Screw Clip

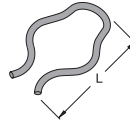

Description	Part No. 733101-	Length	Pkg.
CLP-9	90928	.312	10
CLP-12	90930	.422	

Positive Lock Pins

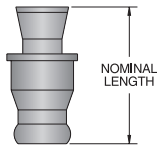

Description	Part No. 733101-	Insert I.C.	Nominal Length	Hex Wrench Size	Pkg.
PL-46	90495	.500	.672	3/32	10
PL-58	90496	.625	.859	1/8	
PL-68	90497	.750	.859	9/64	

Bridge Clamp Seat Screw

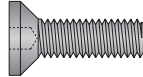

Description	Part No. 733101-	I.C.	Hex Wrench Size	Pkg.
S-4	91005	.375 or .500	1/16	10
S-6	91006	.500 or .750	3/32	
S-10	91007	.625	1/8	

Finger Clamp Screws

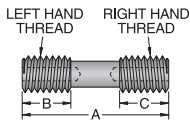

Description	Part No. 733101-	A	B	C	Thread Size	Hex Wrench Size	Pkg.
XNS-26	90900	0.750	.31	.31	8-32	5/64	10
XNS-35	90901	0.625	.22	.22	10-32	3/32	
XNS-36	90902	0.750	.25	.25	10-32	3/32	
XNS-37	90903	0.840	.31	.31	10-32	3/32	
XNS-38	90904	1.000	.37	.37	10-32	3/32	
XNS-46	90905	0.750	.31	.31	1/4-28	1/8	
XNS-47	90906	0.875	.28	.28	1/4-28	1/8	
XNS-48	90907	1.000	.37	.37	1/4-28	1/8	
XNS-58	90910	1.000	.50	.28	5/16-24	5/32	
XNS-59	90911	1.125	.47	.41	5/16-24	5/32	
XNS-510	90908	1.250	.50	.50	5/16-24	5/32	
XNS-512	90909	1.500	.62	.62	5/16-24	5/32	
XNS-610	90912	1.250	.50	.50	3/8-24	3/16	

DorNotch Clamp

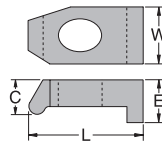

Description	Part No. 733101-	C	E	L	W	Pkg.
CM-72	90694	.37	.31	.86	.43	10
CM-73	90695	.37	.31	.86	.43	
CM-74	90692	.28	.24	.53	.34	
CM-75	90693	.28	.24	.53	.34	

DorNotch Clamp Screws

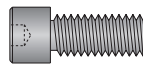

Description	Part No. 733101-	Length	Thread	Hex Wrench Size	Pkg.
S-310	90700	.50	6-32	7/64	10
S-412	90701	.75	10-32	5/32	

Multi-Lock Seat Screw



Description	Part No. 733101-	I.C.	Thread	Hex Wrench Size	Pkg.
S-34	91295	.375	10-32	5/64	10
S-46	91296	.500	1/4-28	3/32	
S-58	91297	.625	5/16-24	1/8	
S-68	91298	.750	3/8-24	9/64	

DorNotch Seat Screw

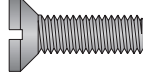

Description	Part No. 733101-	Insert Size	Thread	Hex Wrench Size	Pkg.
SL-344	91008	4	4-40	slotted	10
S-111	91009	6	4-40	1/16	
S-112	91010	8	4-40	1/16	

Turning Insert Torx Screw

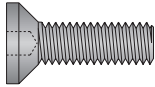

Description	Part No. 733101-	I.C.	Torx Key	Pkg.
TS-25.45-6M1	90970	.250	T-7	10
TS-4.7-10M1	90982	.375	T-15	
TS-103-4M1	90956	.500	T-20	
TS-5.8-10M1	90986	.750	T-20	

Boring Insert Torx Screw

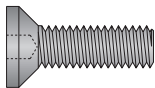

Description	Part No. 733101-	I.C.	Torx Key	Pkg.
TS-06	91306	.156	T-6	10
TS-25.45-6M1	90970	.250	T-7	
TS-4.7-8M1	90976	.375	T-15	
TS-4.7-10M1	90982	.375	T-15	
TS-44-3	90936	.375	T-10	
TS-44-4	90938	.375	T-10	
TS-103-4M1	90956	.500	T-20	
TS-83-4M1	90950	.500	T-20	
TS-83-5M1	90954	.500	T-20	

Threading On Edge Insert Torx Screw

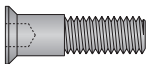

Description	Part No. 733101-	I.C.	Torx Key	Pkg.
GTS-1	90965	.375	T-10	10
GTS-2	90966	.500	T-20	
GTS-3	90967	.625	T-20	
GTS-4	90968	.750	T-30	

Threading Laydown Insert Torx Screw

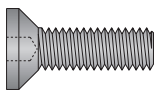

Description	Part No. 733101-	I.C.	Torx Key	Pkg.
TS-06	91306	.1562	T-6	10
TS-08	91308	.1875	T-6	
TS-11	91310	.2500	T-8	
TS-16	91311	.3750	T-10	
TS-22	91312	.5000	T-20	
TS-27	91314	.6250	T-25	

Milling Insert Torx Screw

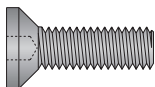

Description	Part No. 733101-	I.C.	Torx Key	Pkg.
TS-06	91306	.156	T-6	10
TS-11	91310	.250	T-8	
TS-25.45-6M1	90970	.250	T-7	
TS-4.7-8M1	90976	.375	T-15	
TS-4.7-10M1	90982	.375	T-15	
TS-1032-5M1	90960	.500	T-20	
TS-83-4	90948	.500	T-20	
TS-5.8-10M1	90986	.750	T-20	

Torx Keys

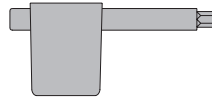

Description	Part No. 733101-
T-6	92001
T-7	92002
T-8	92003
T-9	92004
T-10	92005

Description	Part No. 733101-
T-15	92006
T-20	92007
T-25	92008
T-30	92009

Triangle Chipbreakers

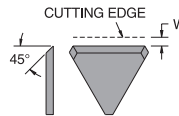

Description	Part No. 733101-	I.C.	Effective Width W	Pkg.
T2AC	90446	.250	.060	10
T3AC	90452	.375	.060	
T3AE	90453	.375	.090	
T3AG	90454	.375	.125	
T4AC	90459	.500	.060	
T4AE	90460	.500	.090	
T4AG	90461	.500	.125	
T5AC	90465	.625	.100	
T5AE	90466	.625	.140	
T5AG	90467	.625	.180	

Square Chipbreakers

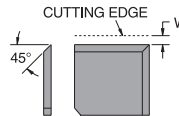

Description	Part No. 733101-	I.C.	Effective Width W	Pkg.
S3BC	90440	.375	.060	10
S4BE	90442	.500	.060	
S6BG	90444	.750	.125	

Threading Shim Seats

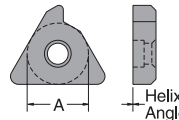

Description	Part No. 733101-	I.C.	Helix Angle	Pkg.
GX-16-1	90380	.375	1-1/2°	10
NX-22-1	90381	.500	1-1/2°	
VX-27-1	90382	.625	1-1/2°	

Use when machining right hand thread with a right hand tool, or left hand thread with a left hand tool.

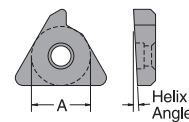

Description	Part No. 733101-	I.C.	Helix Angle	Pkg.
GX-16-98	90385	.375	- 1-1/2°	10
NX-22-98	90386	.500	- 1-1/2°	
VX-27-98	90397	.625	- 1-1/2°	

Use when machining right hand thread with a left hand tool, or left hand thread with a right hand tool.

Positive Square Shim Seats

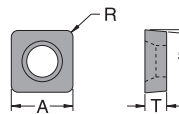

Description	Part No. 733101-	A	T	R	Pkg.
SM-40	90373	.500	.1250	.0156	10
SM-36	90374	.750	.1250	.0469	

Positive Triangle Shim Seats

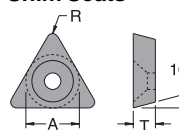

Description	Part No. 733101-	A	T	R	Pkg.
SM-119	90372	.204	.0937	.0156	10
SM-41	90367	.332	.1250	.0156	
SM-37	90366	.452	.1250	.0312	
SM-99	90371	.540	.1875	.0469	

Positive Triangle Shim Seats

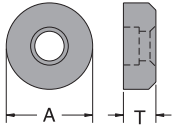

Description	Part No. 733101-	A	T	Pkg.
RS-43P	90375	.500	.1875	10
RS-53P	90376	.625	.1875	
RS-63P	90377	.750	.1875	
RS-83P	90378	1.00	.1875	

Negative Square Shim Seats

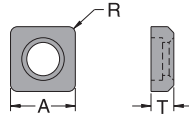

Description	Part No. 733101-	A	T	R	Pkg.
ISSN-322	90050	.375	.1250	.0312	10
ISSN-323	90051	.375	.1250	.0469	
ISSN-332	90053	.375	.1875	.0312	
ISSN-333	90054	.375	.1875	.0469	
ISSN-423	90056	.500	.1250	.0469	
ISSN-432	90057	.500	.1875	.0312	
ISSN-433	90059	.500	.1875	.0469	
ISSN-533	90060	.625	.1875	.0469	
ISSN-633	90062	.750	.1875	.0469	
ISSN-634	90063	.750	.1875	.0625	
ISSN-846	90064	1.00	.2500	.0937	

Negative 80° Diamond Shim Seats

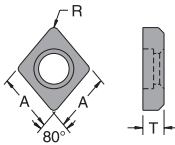

Description	Part No. 733101-	A	T	R	Pkg.
ICSN-322	90003	.375	.1250	.0312	10
ICSN-422	90004	.500	.1250	.0312	
ICSN-423	90005	.500	.1250	.0469	
ICSN-432	90006	.500	.1875	.0312	
ICSN-433	90008	.500	.1875	.0469	
ICSN-533	90010	.625	.1875	.0469	
ICSN-633	90012	.750	.1875	.0469	

Negative Triangle Shim Seats

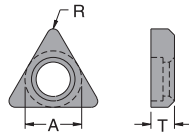

Description	Part No. 733101-	A	T	R	Pkg.
ITSN-322	90084	.375	.1250	.0312	10
ITSN-323	90085	.375	.1250	.0469	
ITSN-324	90086	.375	.1250	.0625	
ITSN-332	90087	.375	.1875	.0312	
ITSN-333	90088	.375	.1875	.0469	
ITSN-334	90089	.375	.1875	.0625	
ITSN-423	90090	.500	.1250	.0469	
ITSN-432	90092	.500	.1875	.0312	
ITSN-433	90093	.500	.1875	.0469	
ITSN-434	90094	.500	.1875	.0625	
ITSN-532	90097	.625	.1875	.0312	
ITSN-533	90098	.625	.1875	.0469	
ITSN-534	90099	.625	.1875	.0625	
ITSN-633	90105	.750	.1875	.0469	
ITSN-636	90106	.750	.1875	.0937	

Negative 55° Diamond Shim Seats

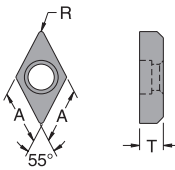

Description	Part No. 733101-	A	T	R	Pkg.
IDSN-322	90016	.375	.1250	.0312	10
IDSN-423	90018	.500	.1250	.0469	
IDSN-432	90020	.500	.1875	.0312	
IDSN-433	90021	.500	.1875	.0469	
IDSN-533	90024	.625	.1875	.0469	
IDSN-534	90025	.625	.1875	.0625	

Negative 80° Trigon Shim Seats

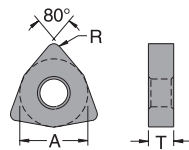

Description	Part No. 733101-	A	T	R	Pkg.
IWSN-322	90070	.375	.1250	.0312	10
IWSN-432	90071	.500	.1875	.0312	
IWSN-433	90072	.500	.1875	.0469	
IWSN-533	90073	.625	.1875	.0469	

Negative 35° Diamond Shim Seats

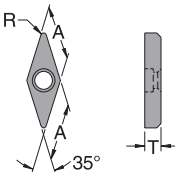

Description	Part No. 733101-	A	T	R	Pkg.
IVSN-322	90065	.375	.1250	.0312	10
IVSN-324	90066	.375	.1250	.0625	
IVSN-432	90067	.500	.1875	.0312	
IVSN-433	90068	.500	.1875	.0469	

DorNotch Shim Seats

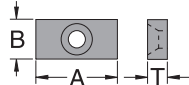

Description	Part No. 733101-	A	B	T	Pkg.
SM-416	90401	.8125	.375	.1875	10
SM-419	90402	.7344	.422	.1875	
SM-420	90400	.8750	.250	.1875	

Negative Round Shim Seats

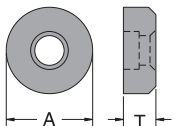

Description	Part No. 733101-	A	T	Pkg.
IRSN-32	90030	.375	.1250	10
IRSN-43	90031	.500	.1875	
IRSN-53	90032	.625	.1875	
IRSN-63	90033	.750	.1875	
IRSN-84	90034	1.00	.2500	

Boring Bar Cartridge

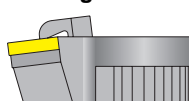

Description	Part No. 733101-	TNMG Gage Insert	Seat	Lock Pin	Clamp	Clamp Screw
BBC-22T	91315	221	—	NL-23	—	—
BBC-32T	91316	322	ITSN-322	NL-34	CL-6	XNS-36
BBC-43T	91317	432	ITSN-432	NL-46	CL-9	XNS-59
BBC-54T	91318	543	ITSN-533	NL-58	CL-9	XNS-59